



Rear Elevation

Mosman House

Prince Albert Street, Mosman NSW 2088

A contemporary pavilion and floating timber box are discretely juxtaposed against a carefully revived grand federation locally listed heritage house in Mosman.

The ground floor entry, living and outdoor areas flow seamlessly from the rooms of the original home opening up to covered outdoor areas, rear lawn and swimming pool.

The garden setting contributes to the streetscape character and locally listed neighbourhood, the grandeur of the original residence has been retained and enhanced.

To the rear, the timber box floats over the main living space supported on steel blades. The box is concealed behind existing terracotta tile roof of the original house when viewed from the street. Skylights intersect the junction between the original hipped roof and modernist box, allowing light to penetrate the centre of the plan, passing through voids in the first floor. High level ribbon windows below the box balance the light in the main living spaces.

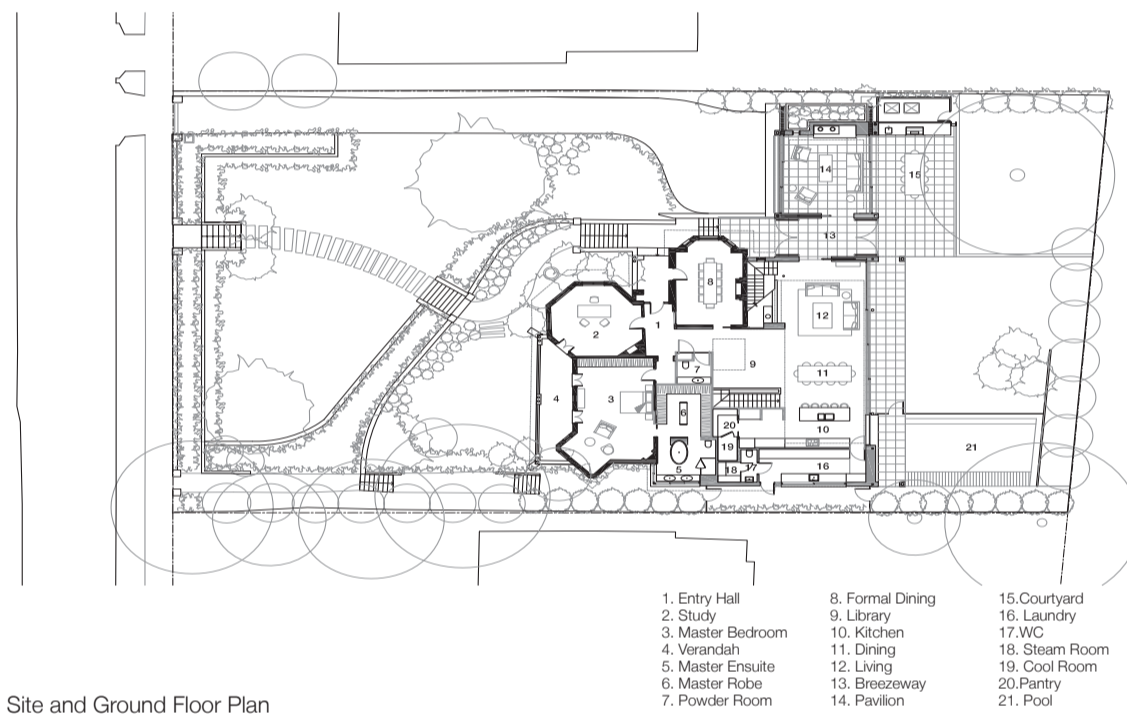

Site and Ground Floor Plan



The Pavilion



Contemporary Northern Pavilion



The main living area opening seamlessly onto a level lawn and dense landscaping